

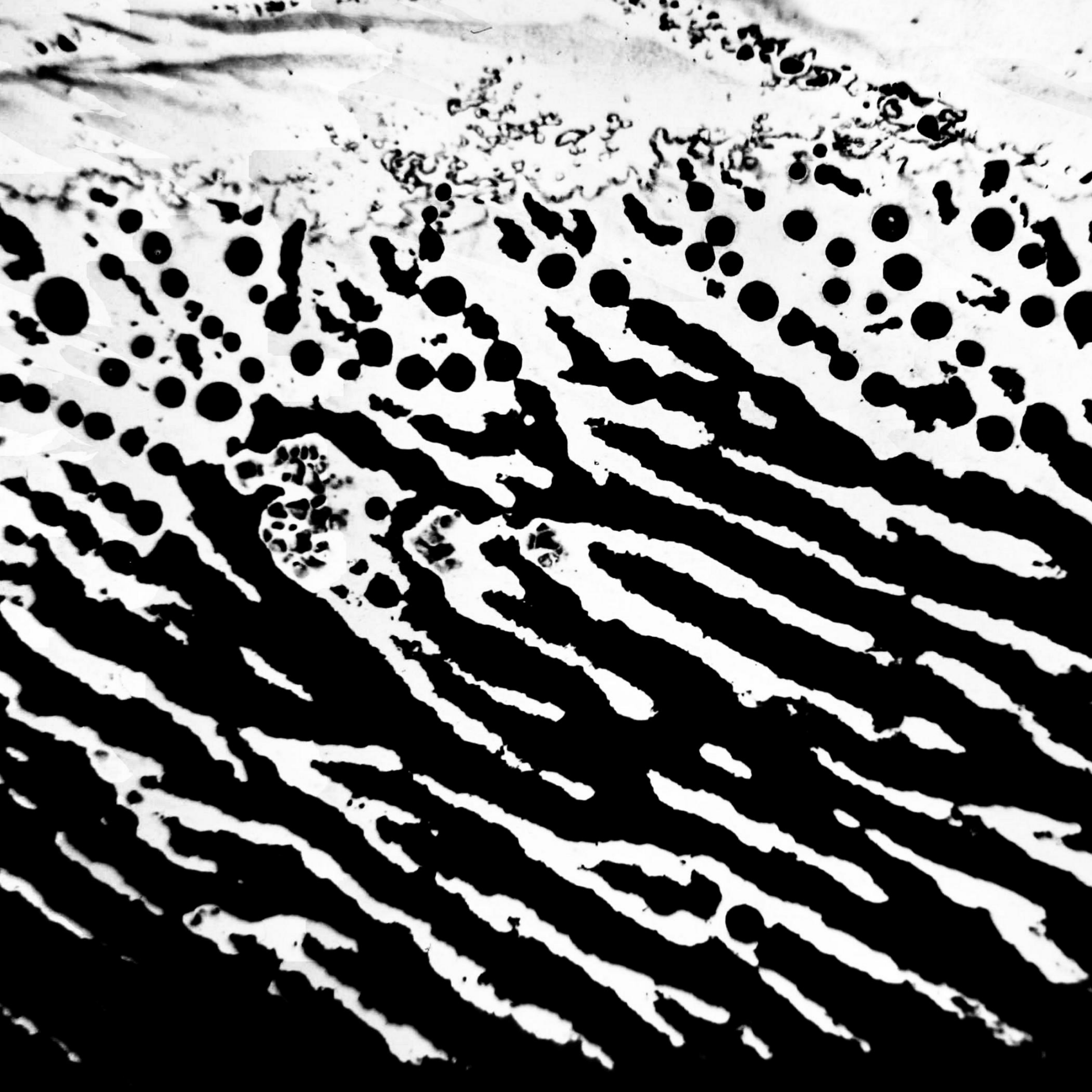

GUY BAEKELMANS

een spirituele reis
un voyage spirituel
a spiritual journey

PRAELUDIUM
1960-1968





Untitled 1961/1963
solarisation on bromide paper, 16 x 24 cm

FIGURES AND FORMS
1968-1971

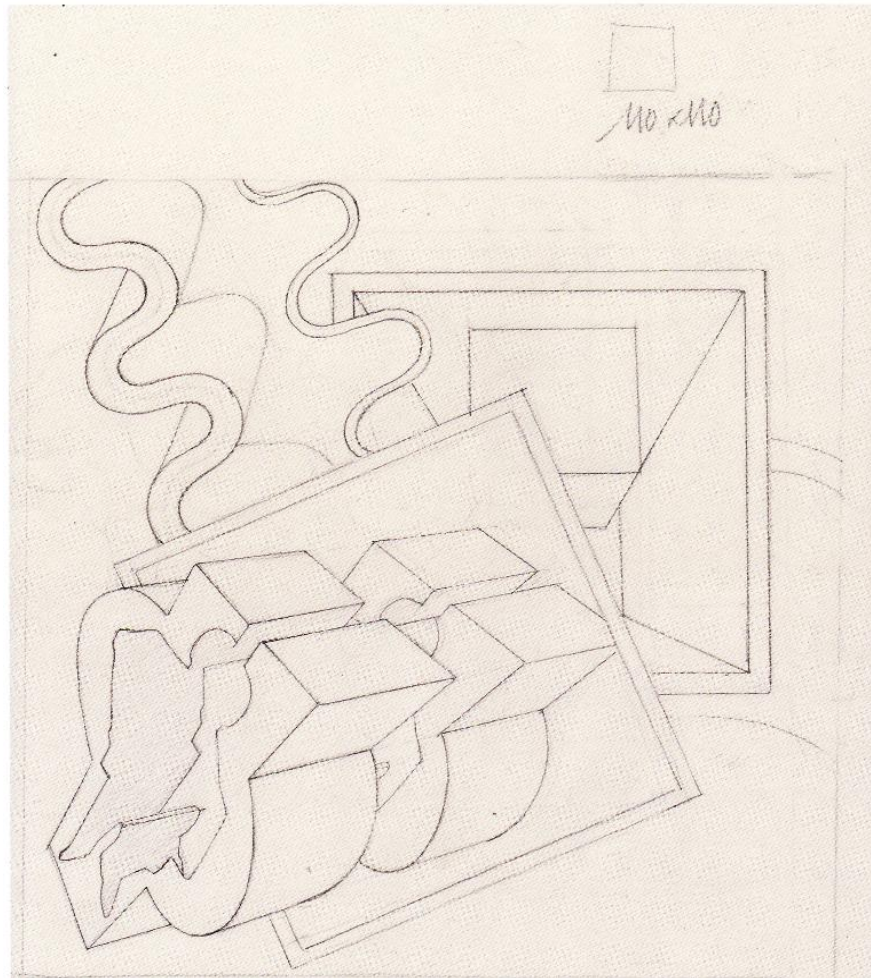
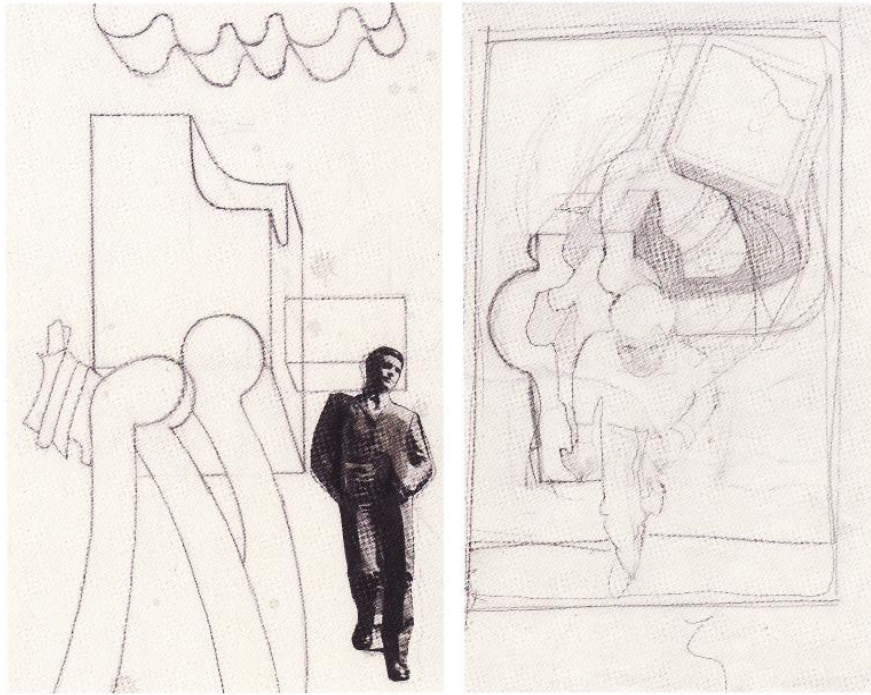

pencil and photograph on paper
untitled 1969



Figures and forms, Standing firm, 1970
tempera on canvas, 130 x 97



Figures and forms Ffc8, 1970
tempera on canvas, 95 x 75

TENSIVE SPACES
1971-1972

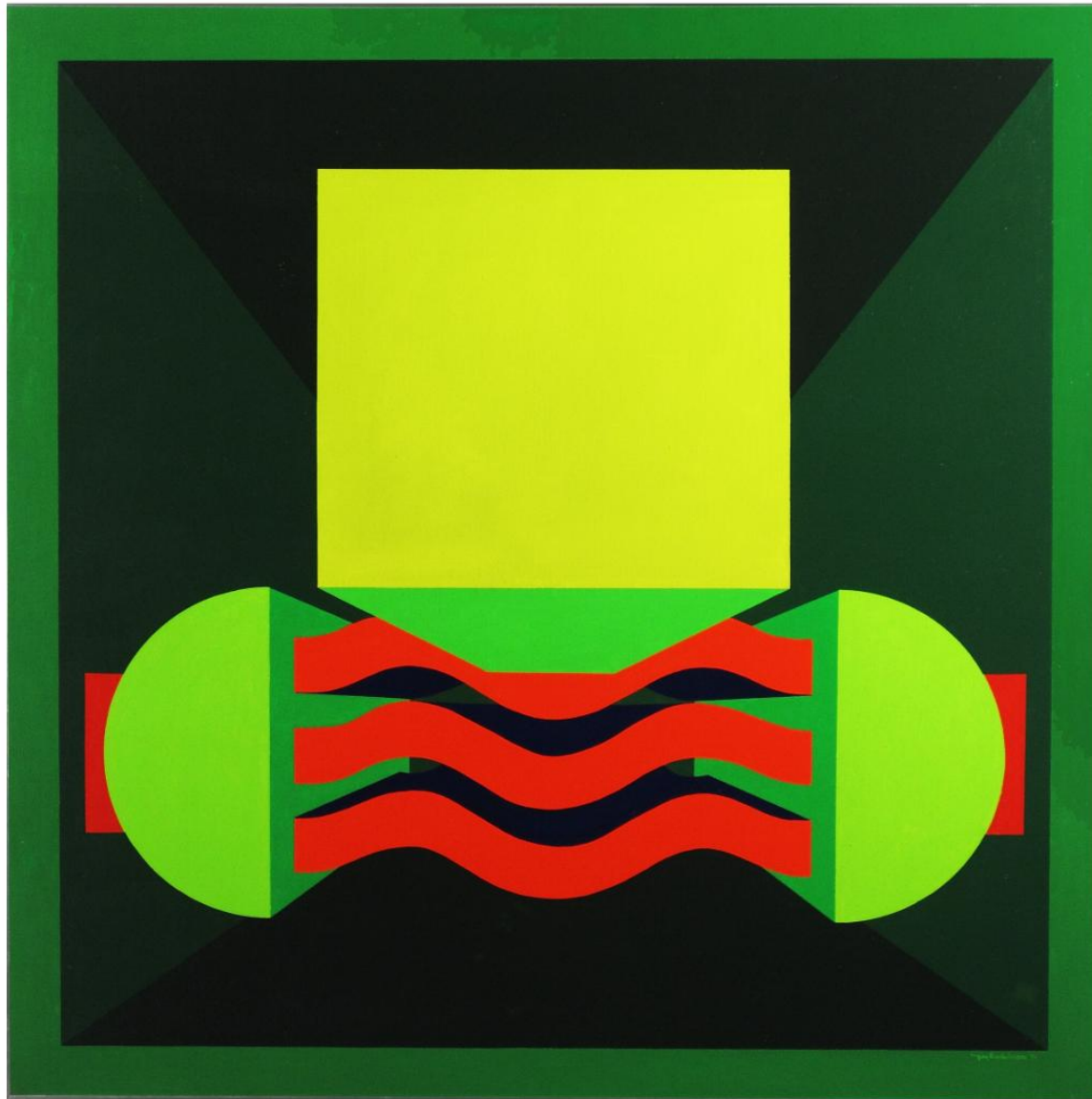

Tensive spaces TSc5,1972
Tempera on canvas, 110 x 110 cm

FREE ARCHITECTONICS
1972-1974

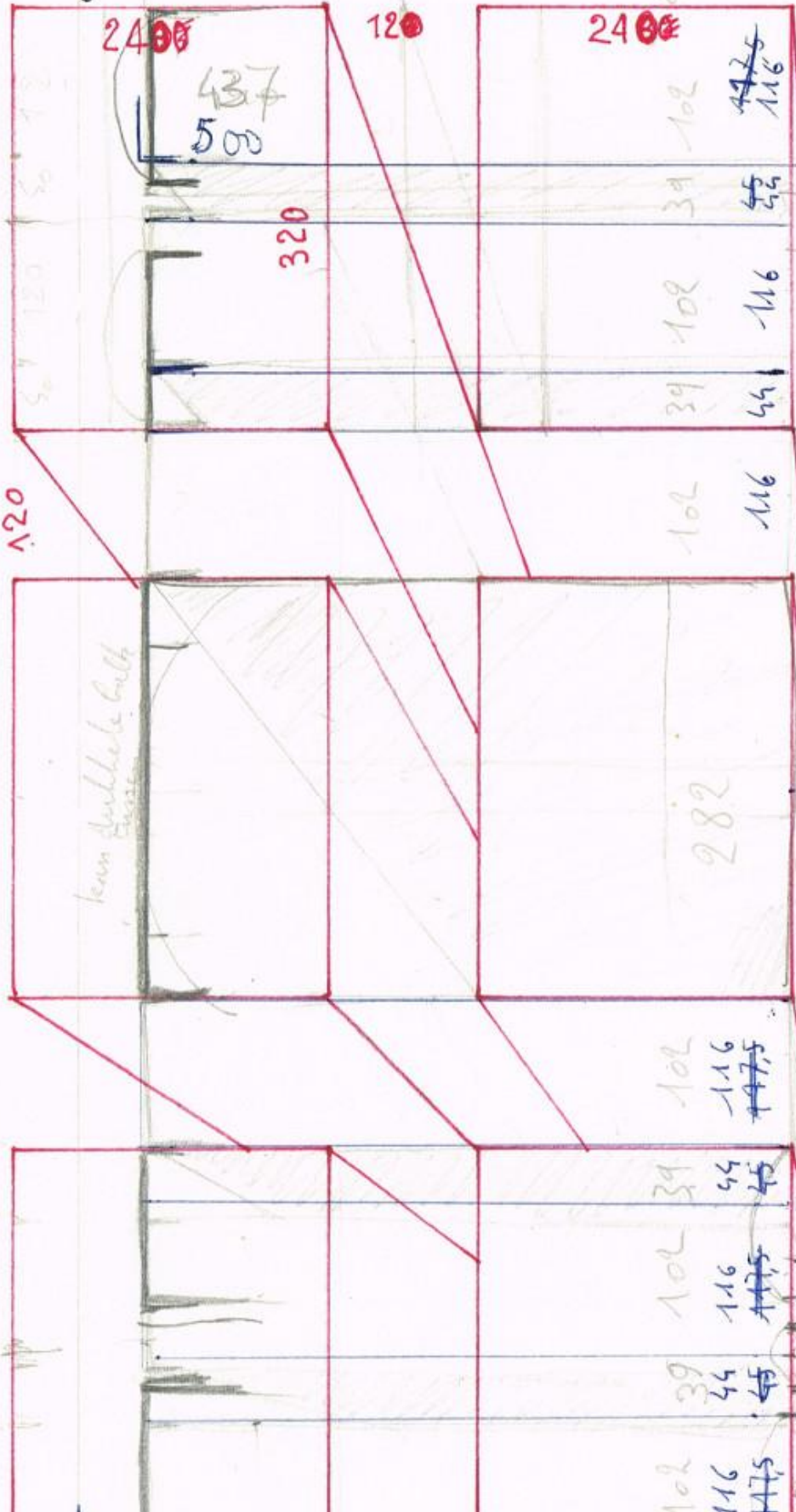

240

120

240

200

A

437
500

320

120

Kann auch beibehalten

39 102 39 102 39 102
44 116 44 116 44 116

102 116

235 58 235 82 235 74
85 85 85 85 85 85
90 85 90 85 90 85

282

282

282

204

102 39 102 39 102 39
116 44 116 44 116 44

40 85 40 85 40 85
25 25 25 25 25 25
33 33 33 33 33 33

85 85 85 85 85 85
75 75 75 75 75 75

282

110
+ 110

~~120~~
120
+ 120

150
+ 150

(12)

120
+ 120

97

65
345
410



Free architectonics FAc11, 1974
acrylic on canvas, 130 x 130 cm

PLANE STRUCTURES
1974-1978

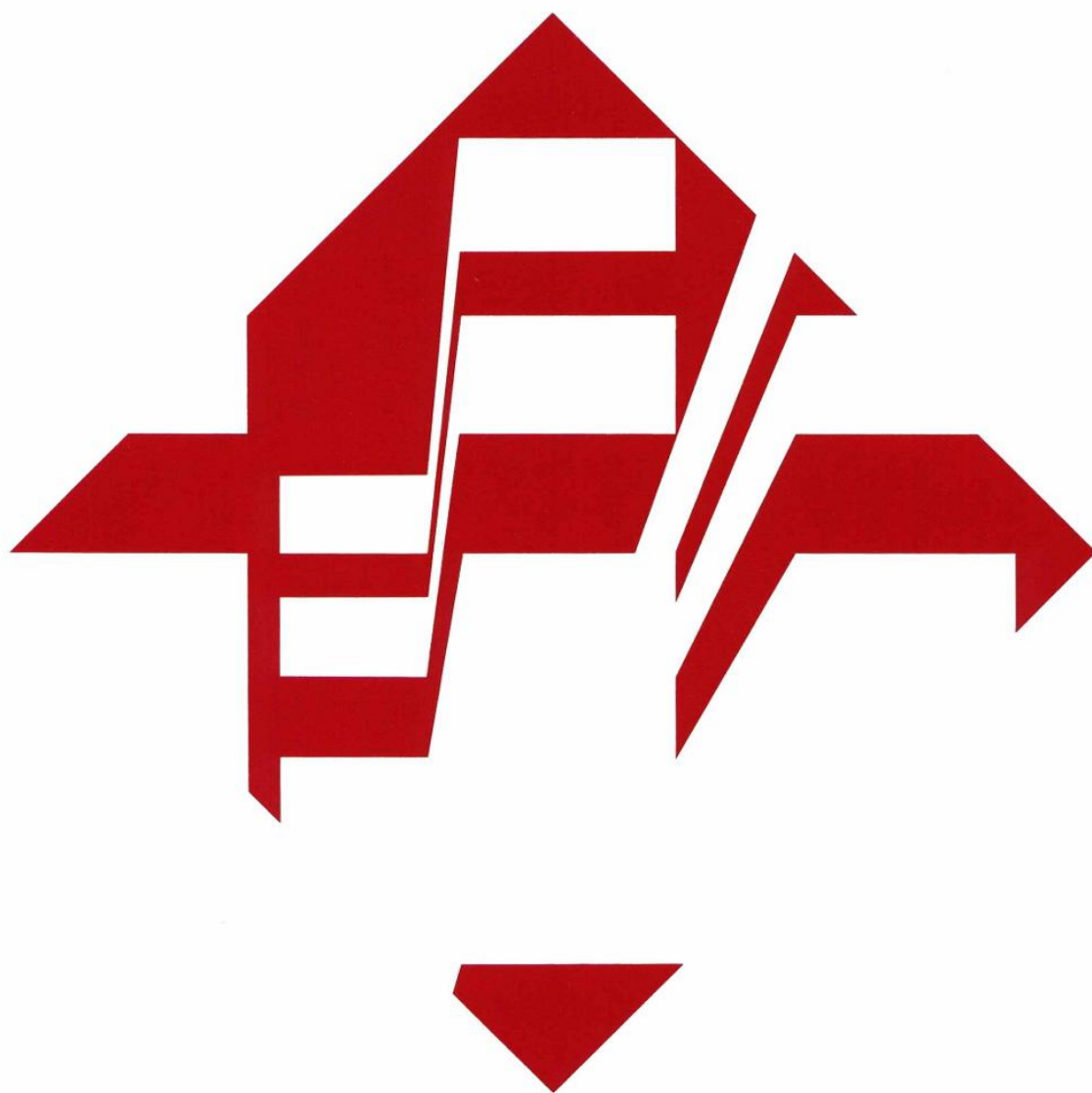

PSs 18 x 18 cm 1978

CONSTRUCTED INTERACTIONS
(as fractions in cosmic relationship)
1979-1984



Constructed interactions (as fractions in cosmic relationship) CIIcC20, 1984
acrylic on canvas, 180 x 180 cm



ギーバーケルマンス



calligraphy, 1982

Ink, paper, 35 x 21

namecard with hanko, 1982

Ink, seal, paper, 5,5 x 9,5 cm



Constructed interactions (as fractions in cosmic relationship) ClcT2, 1981
acrylic on canvas, 116,8 x 116,8 cm (x3)

MATTER AND MORE

Light sculptures

1981-1982



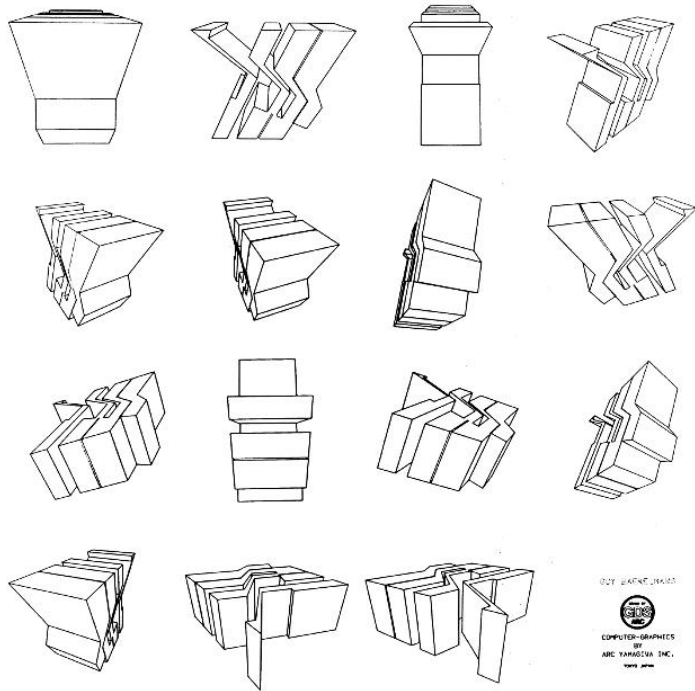

Computer Graphic by Arc Yamagiwa, Tokyo, 1982

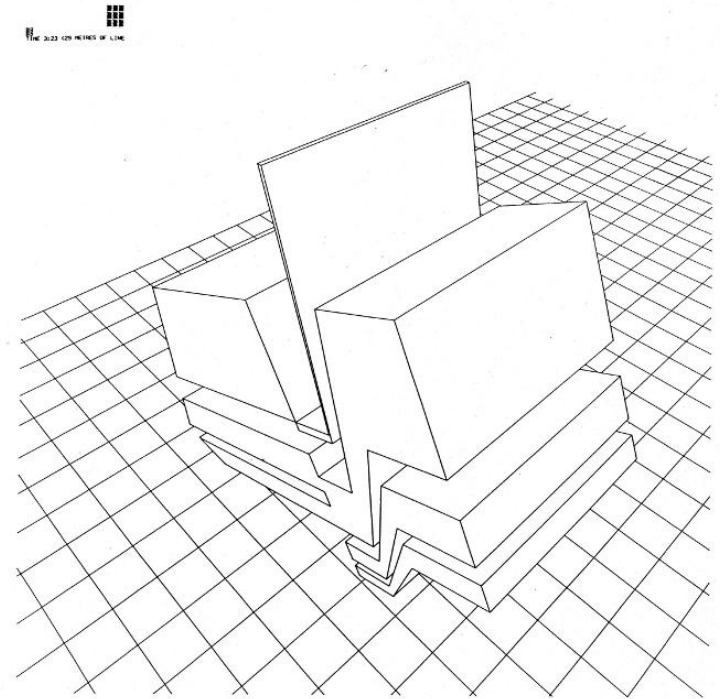

Computer Graphic by Arc Yamagiwa, Tokyo, 1982

Computergraphics by Acc Yamagiwa, Tokyo, 1982
 plotter print on tracing paper, 70 x 70 cm & 66,5 x 66,5

EARTH-MIND-HEAVEN
1984-1987

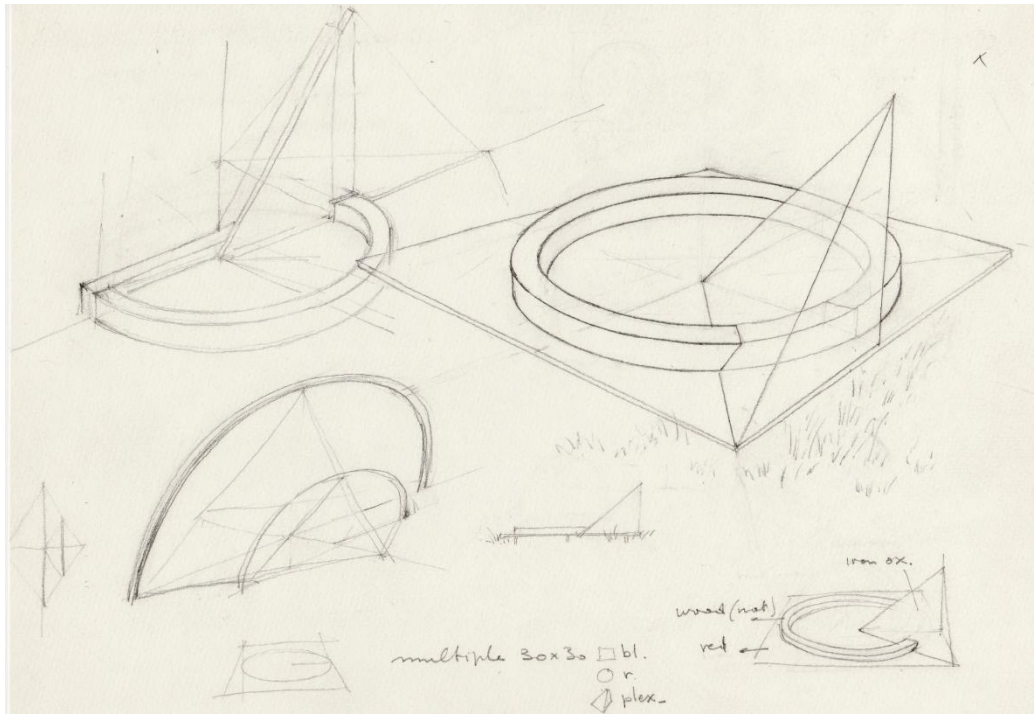

Earth-mind-heaven, untitled, 1984
pencil on paper, 36,5 x 27,5 cm



Earth-mind-heaven, Changes, 1986
wood, height: 210 cm

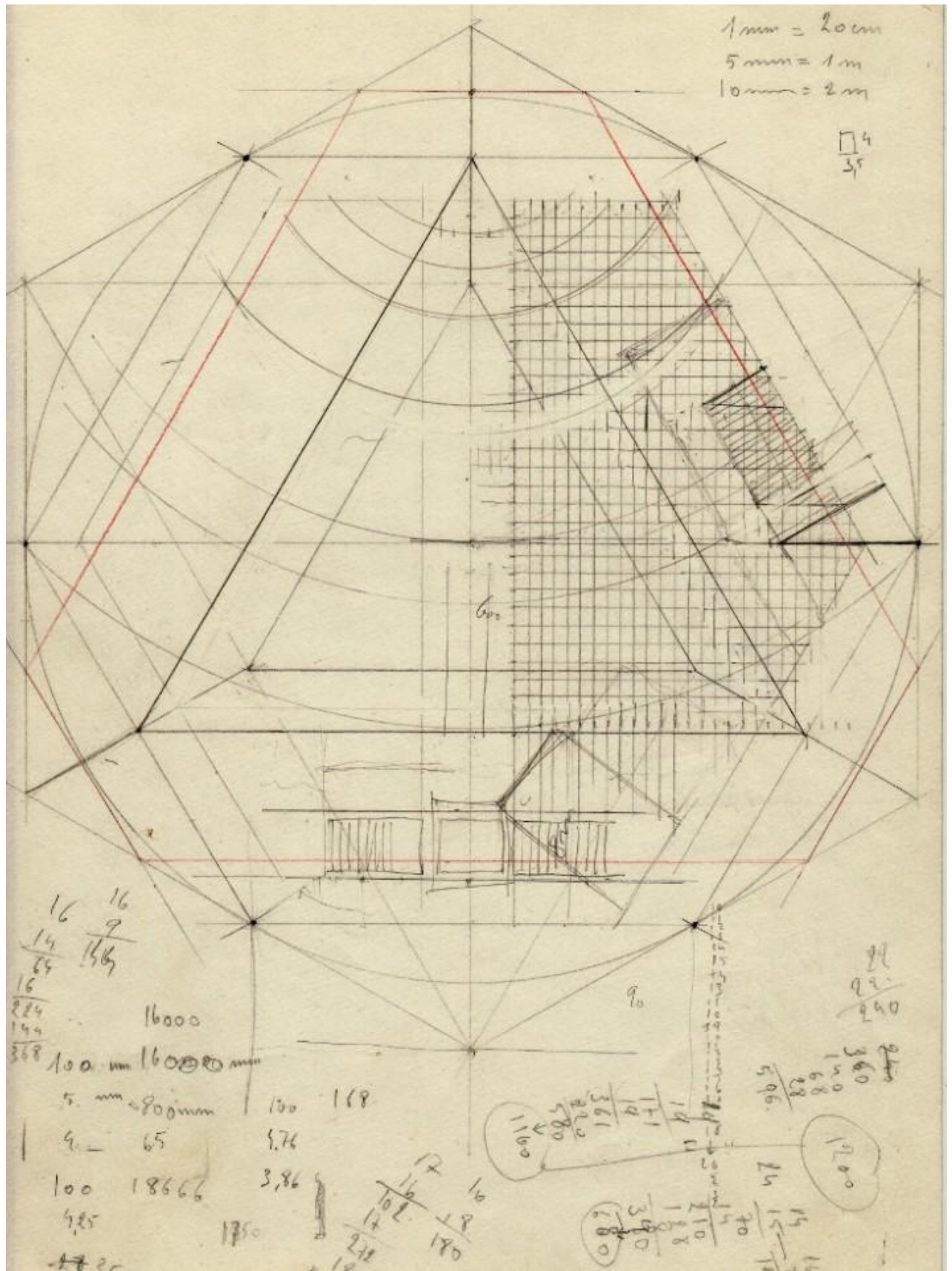

Earth-mind-heaven
 architecture draft, 1988
 Pencil on paper, 29,5 x 21 cm

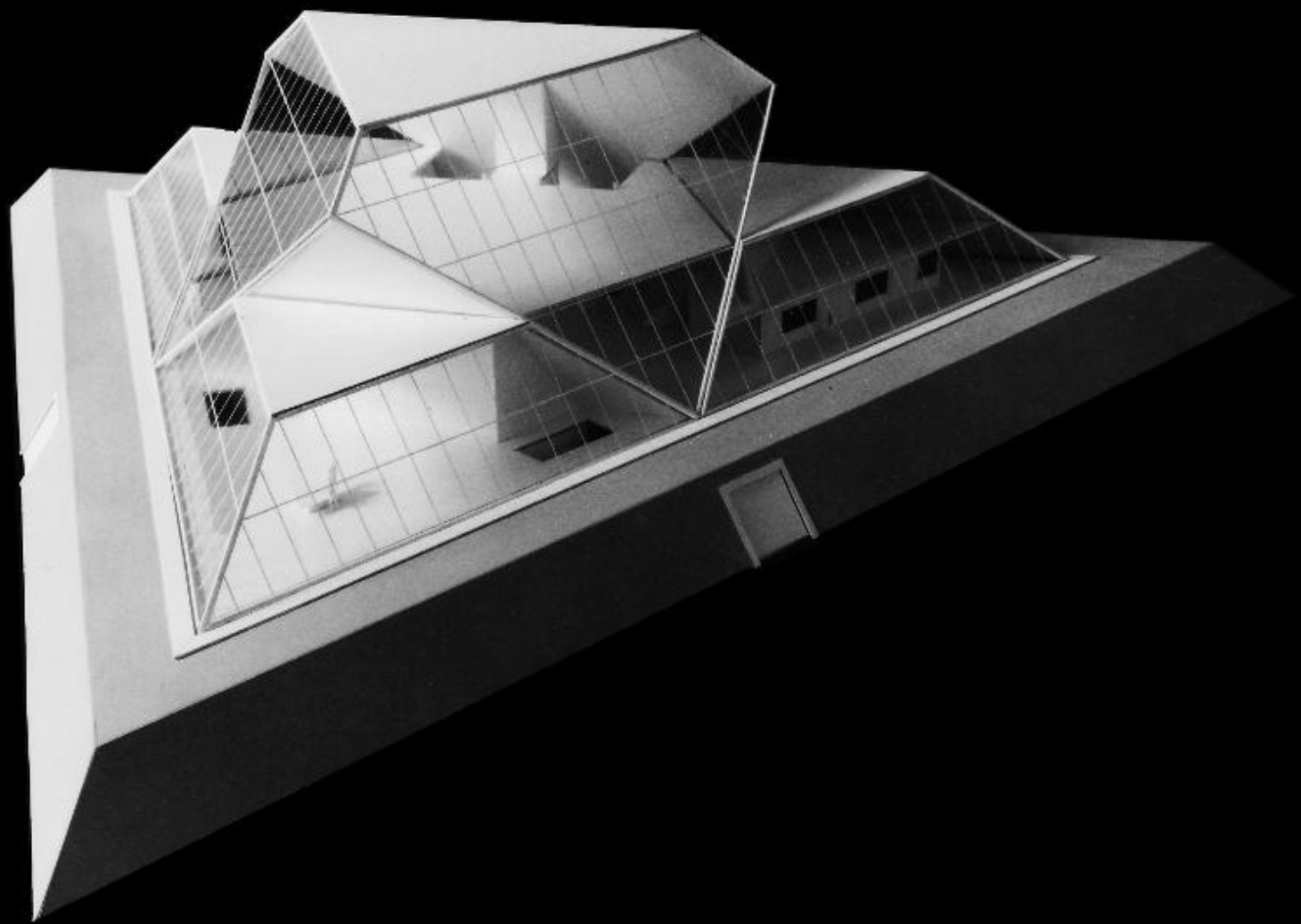

COSMIC RIDDLES AND MACARONICS
1990-1993



Cosmic riddles and macaronics, CRM4, 1991
acrylic on wood, 180 x 110 cm

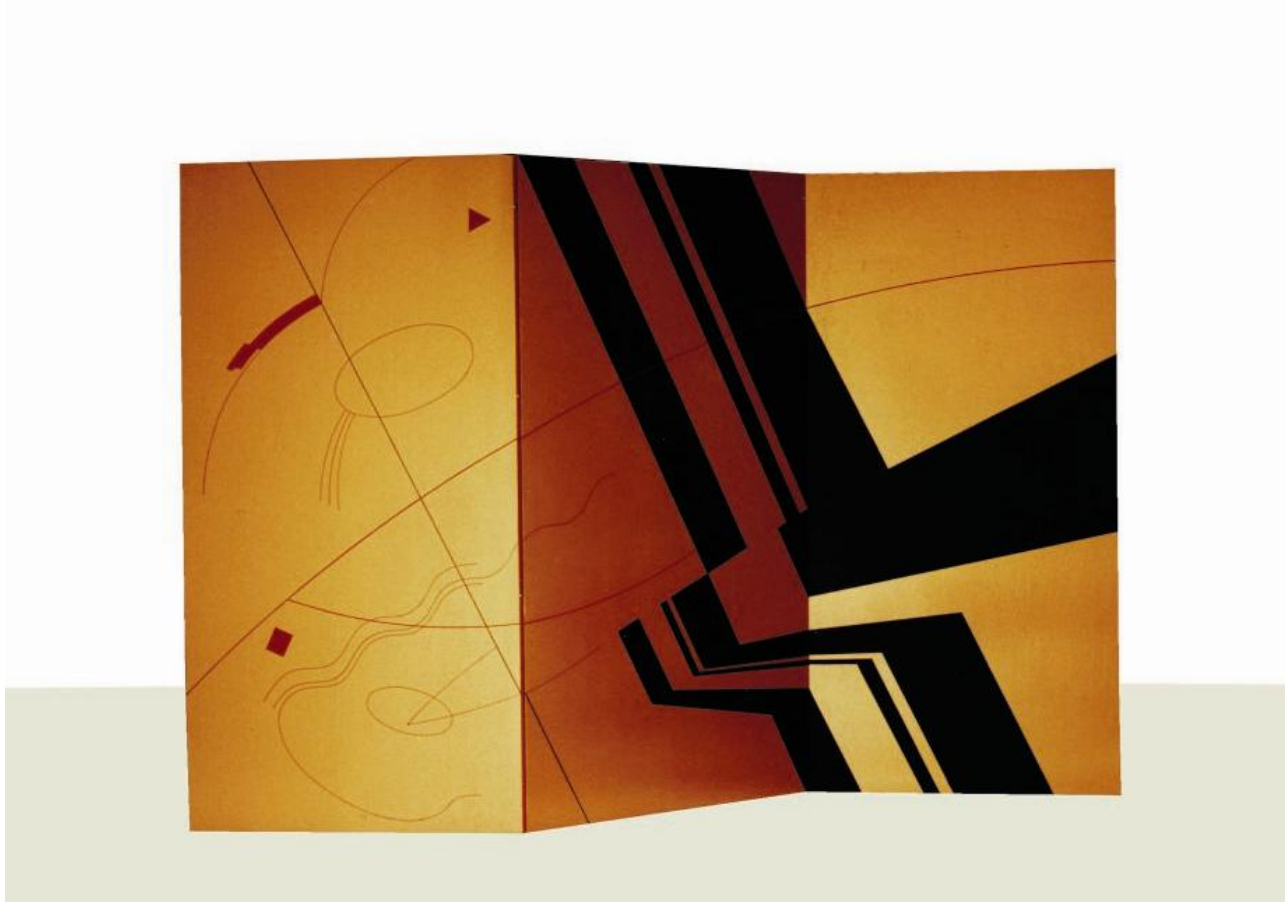

Cosmic riddles and macaronics, folding screen, 1993
acrylic on multiply, 140 x 210 cm

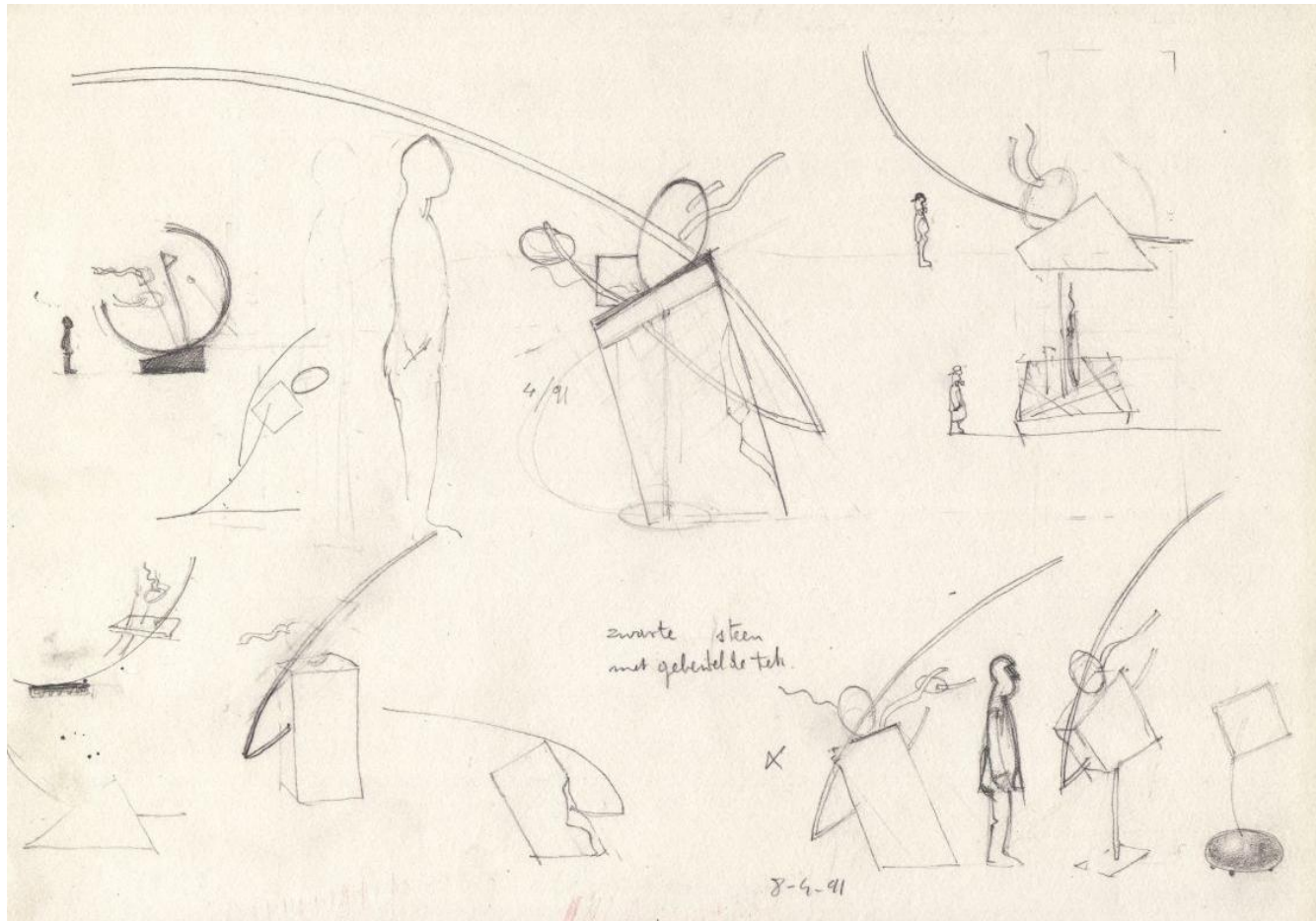

Cosmic riddles and macaronics, untitled, 1991

Pencil on paper, 21 x 30 CM



Cosmic riddles and macaronics, Cosmogonics I and II, 1992
Wood, paint, copper, 100 x 100 x 14 cm

BEYOND IMAGINATION
1994-1997



Eyond imagination, Meeting with the Lotus Sutra, April 1994
acrylic on wood, 150 x 150 cm

Sept. 94

~~2~~ brain of

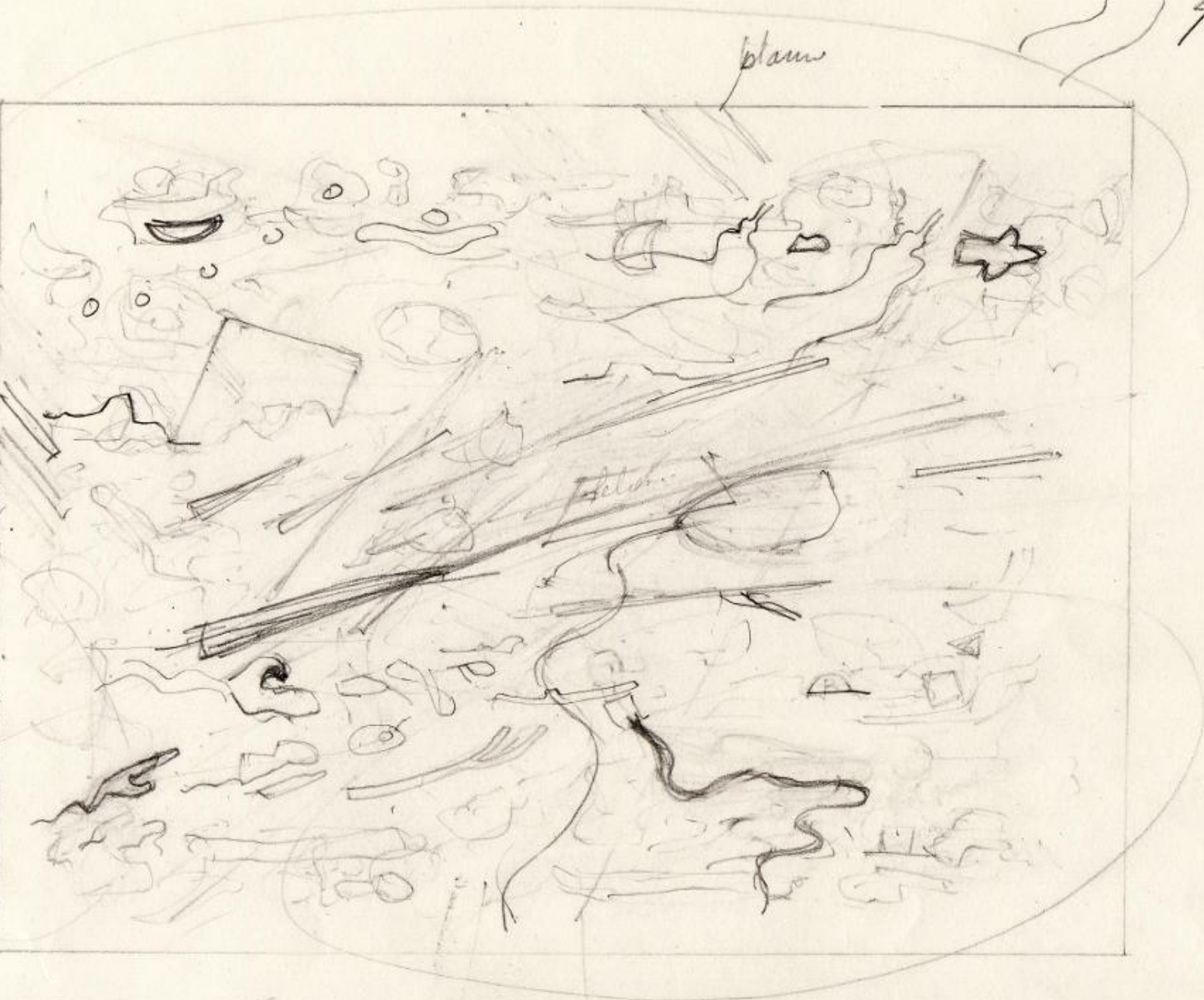

- 1. g...
- 2. g...
- 3. li...

outer

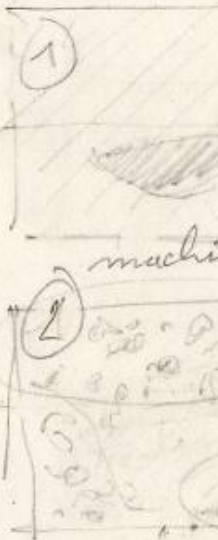

much

much

elke worm of such is a composite

has a lateral intestine nodip (groove band)

has its withdrawn + nothing of green ridging

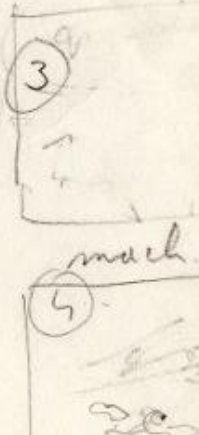



Beyond imagination, Heavenly deities and spirits watching over Mount Sumeru, May 1995
acrylic on wood, 240 x 420 cm

BEYOND KNOWLEDGE
1997-2001



Tree, Two, One, 2002
wood, paint, height: 450 cm

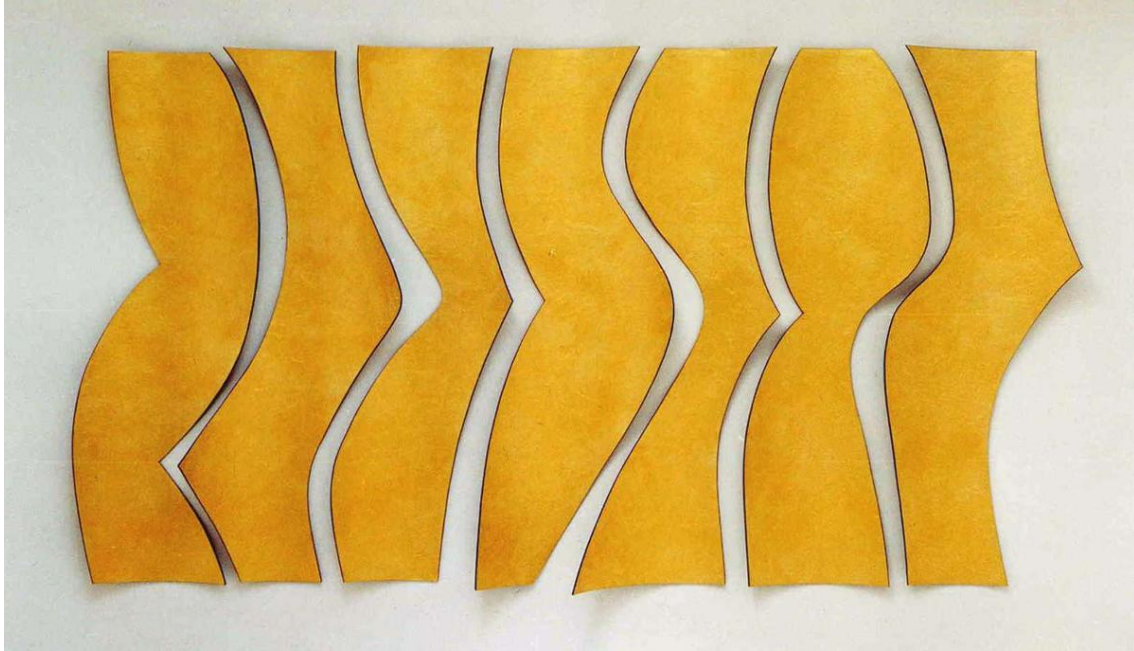

Beyond knowledge, Open, embrace and protect OEP1, 1997
Paint on hardbord, 160 x 300 cm

بِسْمِ اللَّهِ الرَّحْمَنِ الرَّحِيمِ
الْحَمْدُ لِلَّهِ الَّذِي
خَلَقَ الْمَوْتَادَ
مِمَّا يَشَاءُ وَيَخْتَارُ
لَوْ كَانَ مِنْ عِندِ
غَيْرِ اللَّهِ لَفَسَدَتِ
السَّمَاوَاتُ وَالْأَرْضُ
بِالْحَمْدِ لِلَّهِ
الَّذِي خَلَقَ الْمَوْتَادَ
مِمَّا يَشَاءُ وَيَخْتَارُ
لَوْ كَانَ مِنْ عِندِ
غَيْرِ اللَّهِ لَفَسَدَتِ
السَّمَاوَاتُ وَالْأَرْضُ

بِسْمِ اللَّهِ الرَّحْمَنِ الرَّحِيمِ
الْحَمْدُ لِلَّهِ الَّذِي
خَلَقَ الْمَوْتَادَ
مِمَّا يَشَاءُ وَيَخْتَارُ
لَوْ كَانَ مِنْ عِندِ
غَيْرِ اللَّهِ لَفَسَدَتِ
السَّمَاوَاتُ وَالْأَرْضُ
بِالْحَمْدِ لِلَّهِ
الَّذِي خَلَقَ الْمَوْتَادَ
مِمَّا يَشَاءُ وَيَخْتَارُ
لَوْ كَانَ مِنْ عِندِ
غَيْرِ اللَّهِ لَفَسَدَتِ
السَّمَاوَاتُ وَالْأَرْضُ

Beyond knowledge, Writings, 1997
ink on paper, 29,5 x 21 cm



Beyond knowledge, untitled, 1997
Ink on paper, 41 x 59 cm,

GATES OF TRANSFORMATION

2001-2005



Gates of transformation GTI, 2001
acrylic-casein paint on wood, 244 x 154 cm

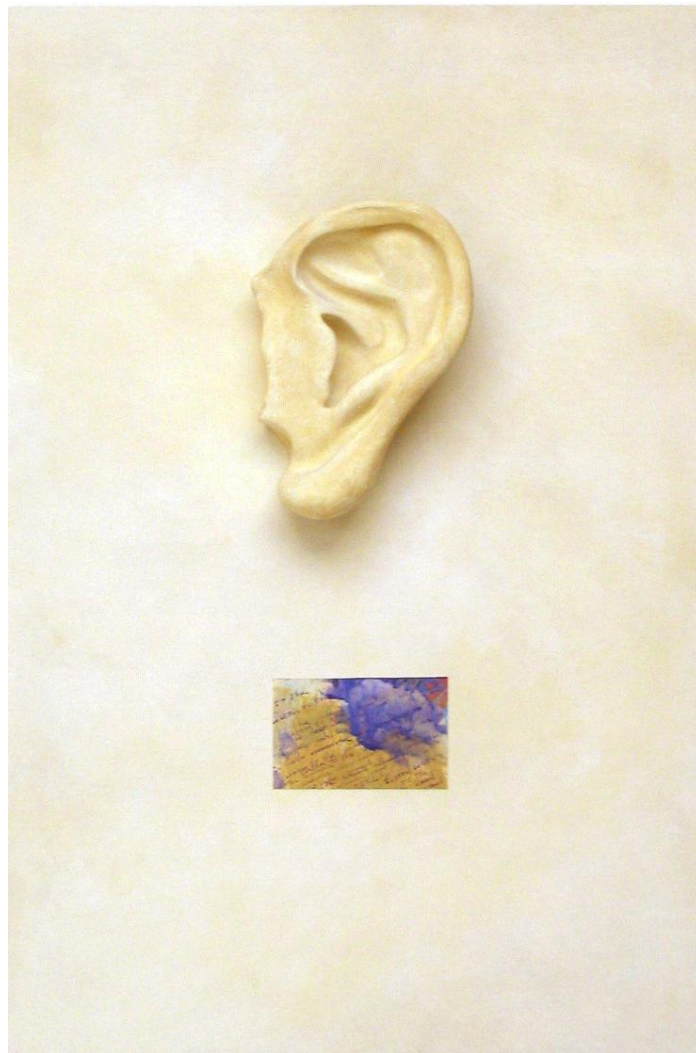

Gates of transformation, Listen to the sound of the universe, 2003
polyester, acryl-casein paint on wood, paper, 103 x 70 cm

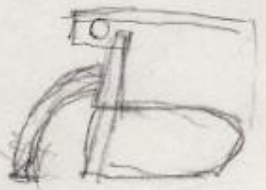
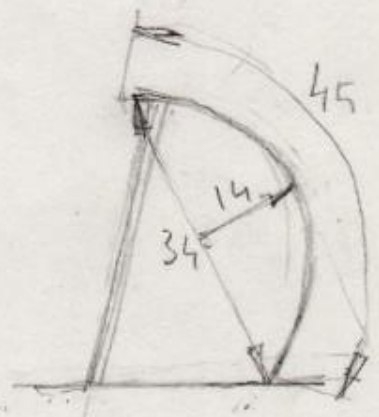
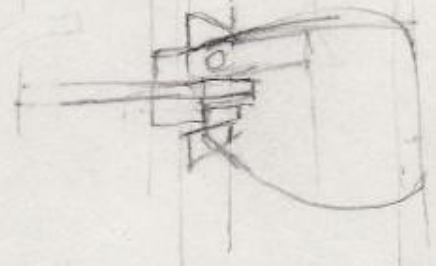
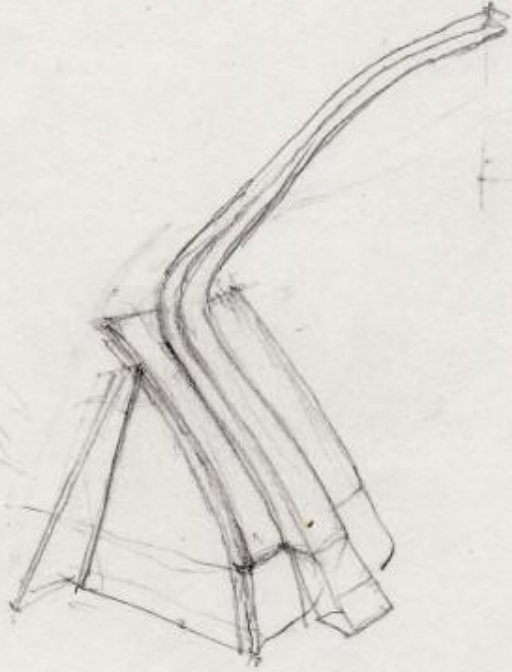
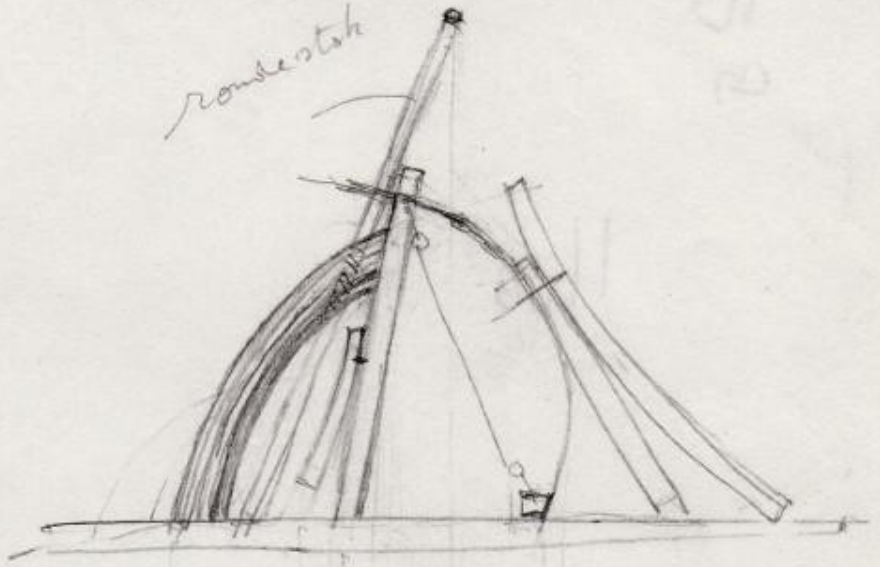
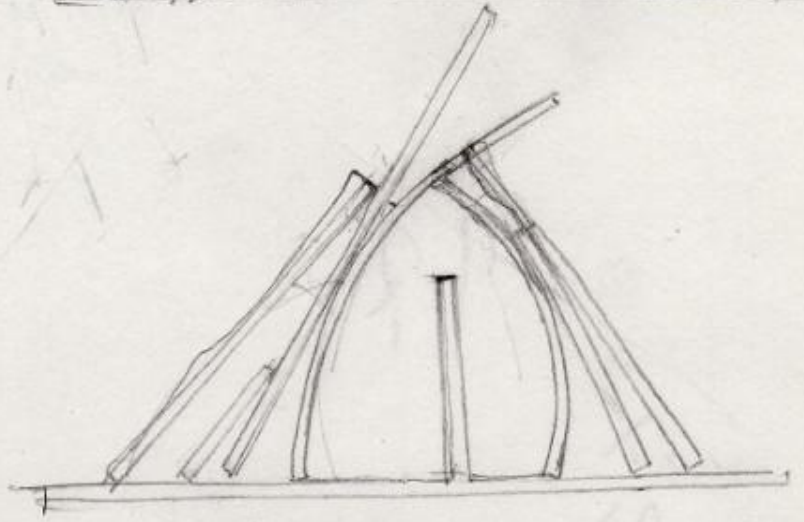
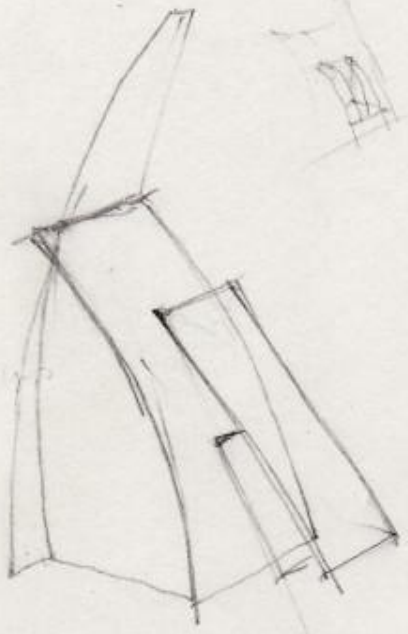



Gates of transformation, Alaya 2, 2003
Wood, paint, 50 x 57 x 47 cm

SIMULTANEOUS WORLDS
2005-2009

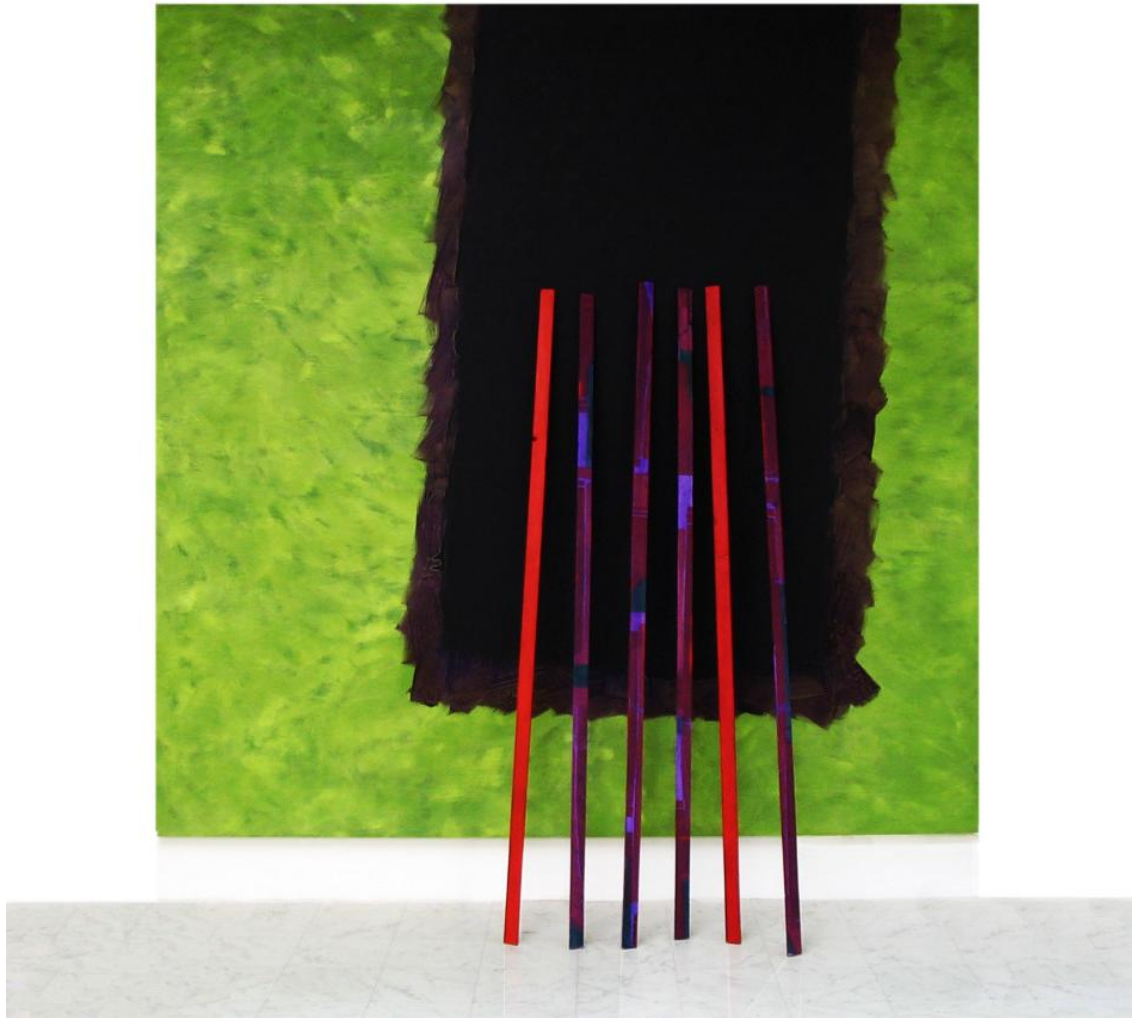

Simultaneous worlds; Six red sticks, 2004
Acryl-casein paint on wood, 240 x 240 cm

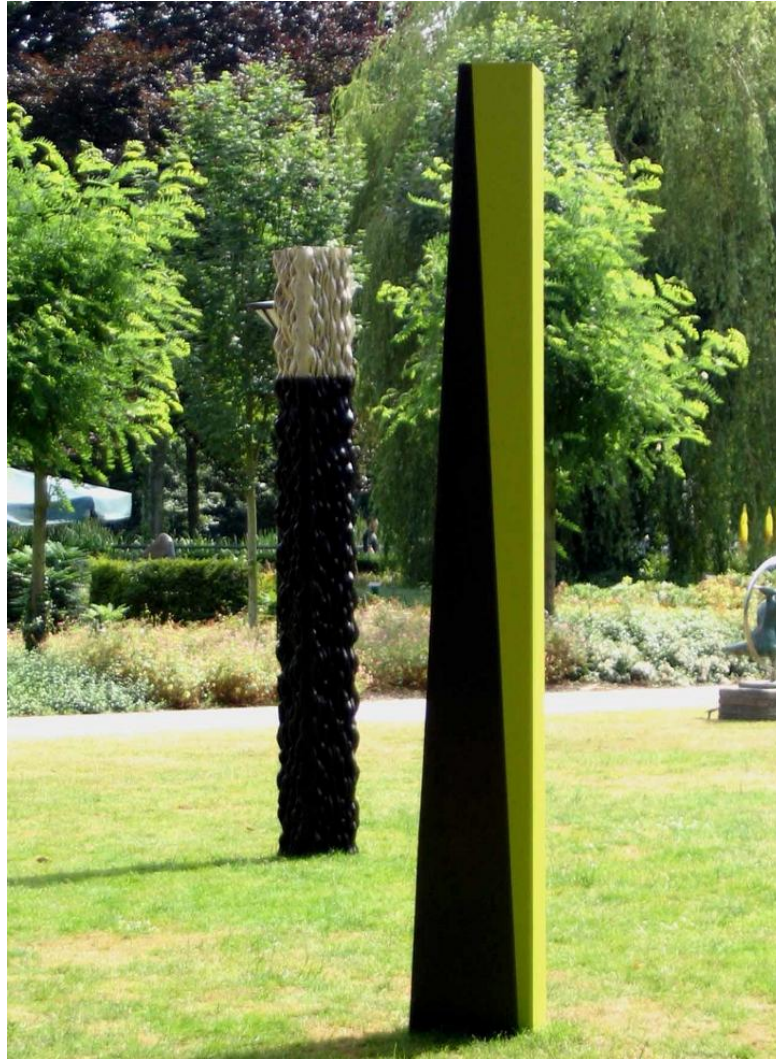

Simultaneous worlds, Funi 1 & Funi 2, 2005
Wood, paint, 250 x 35 x 29 cm



Simultaneous worlds, Re-formation I, 2006
Acryl-casein paint on wood, 120 x 100 cm



Simultaneous worlds, Transformer I, 2008
Acryl-casein paint on wood, 120 x 160 cm

DRAGON WAGONS
AND WHEELS OF WISDOM
2010-2013



Dragon wagons and wheels of wisdom WoW Circle 1, 2010
Acryl-casein paint on wood, mirror, diameter: 80 cm

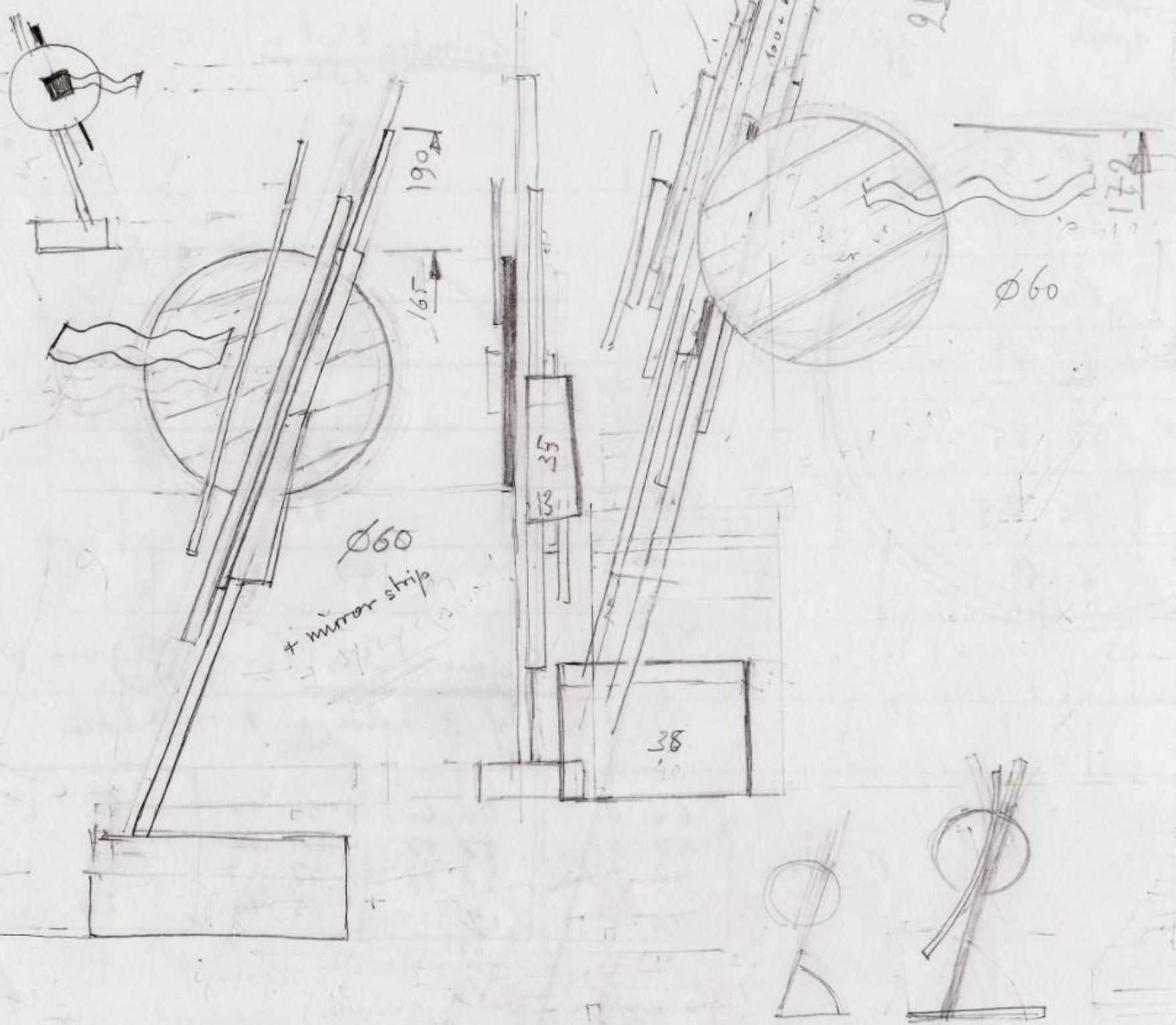

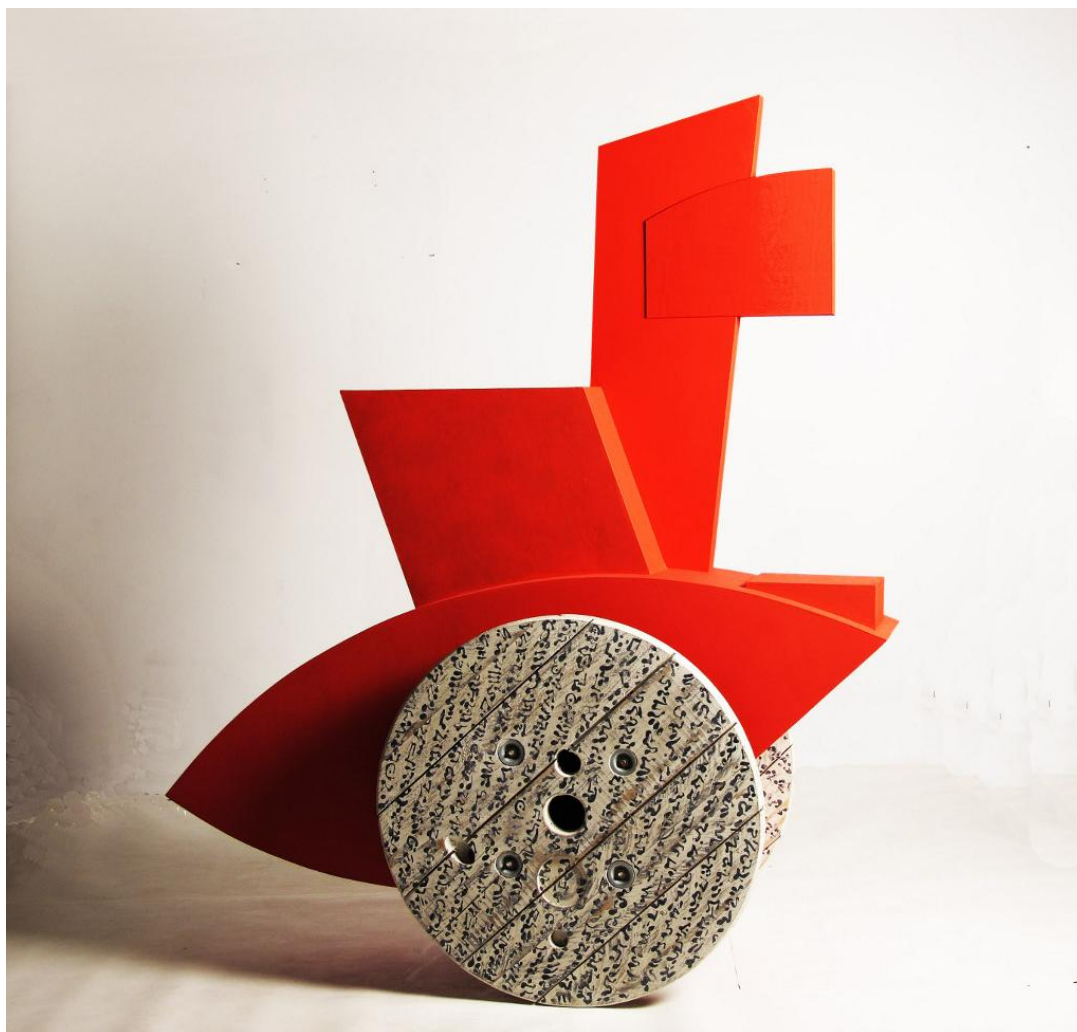

Dragon wagons and wheels of wisdom, DW 1, 2010

Paint on wood, 187 x 165 x 50 cm

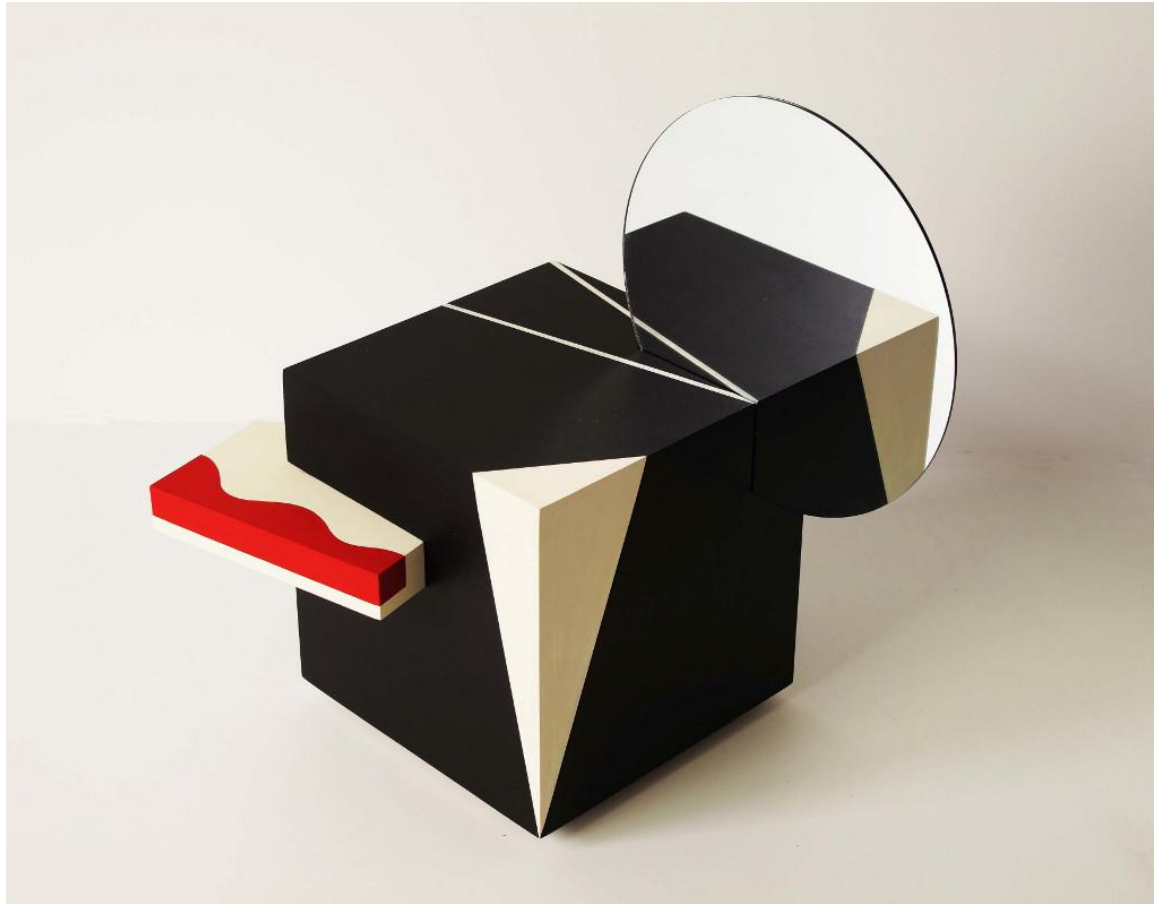

Dragon wagons and wheels of wisdom, WoW Cubic 1, 2012
Paint on wood, mirror, 40 x 37 x 30 cm

CYCLIC AND ELLIPTIC SWINGS
2013

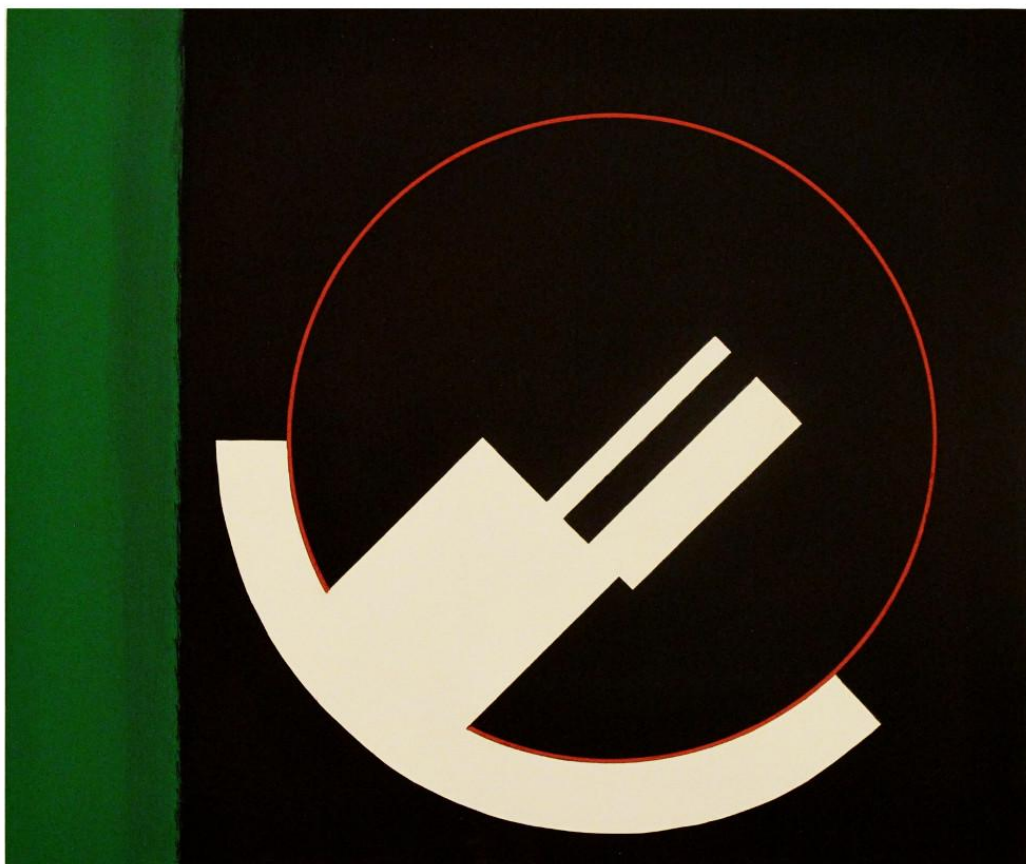

Ciclic and elliptic swings, Comp 1, 2013
acryl-casein paint on wood, 47 x 56 cm

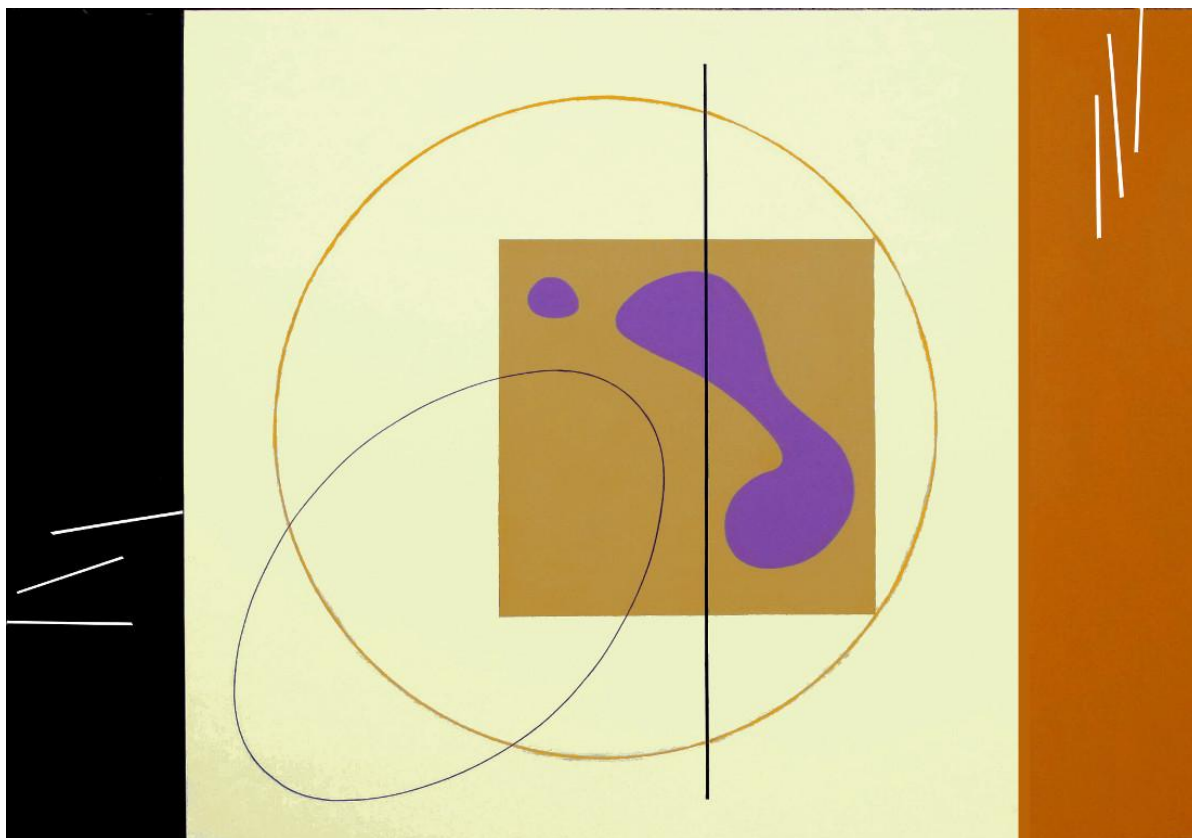

Ciclic and elliptic swings, Comp 11, 2013
acryl-casein paint on wood, 89,4 x 128,5 cm